

# LOCAL East University

# 10

Service Monday – Friday  
No Holiday service  
CHECK [RIDEDART.COM](http://RIDEDART.COM) FOR  
HOLIDAY SERVICE INFORMATION.  
**Platform M**

**Route Destinations** ▼  
 Pleasant Hill Park and Rides ▼  
 Iowa State Fairgrounds ▼  
 Broadlawns East University Clinic ▼  
 Downtown ▼  
 DART Central Station ▼



All Trips  
  
 Accessible

DES MOINES AREA REGIONAL TRANSIT AUTHORITY  
 515-283-8100 ▶ [ridedart.com](http://ridedart.com)

## Pass Sales Outlets

### Price Chopper

3425 Ingersoll Ave.: Rt. 11, 60  
 1819 Beaver Ave.: Rt. 5  
 4343 Merle Hoy Rd.: Rt. 5, 14, 16, 50  
 5440 NW 86th St., Johnston: Rt. 93

### Cash Saver

4121 Fleur Dr.: Rt. 8  
 1320 E. Euclid Ave.: Rt. 4, 50

### DART Administrative Offices

620 Cherry St.: All Local Routes

### E-Z Money Check Cashing

2910 E. University Ave.: Rt. 1, 10  
 1238 E. 14th St.: Rt. 4, 10, 17  
 904 Army Post Rd.: Rt. 7

### Hy-Vee Drugstore

42nd & University Ave.: Rt. 3, 60

### Hy-Vee Food Stores

3330 Martin Luther King Jr. Pkwy.: Rt. 16  
 2540 E. Euclid Ave.: Rt. 17, 50  
 3221 SE 14th St.: Rt. 6  
 4707 Fleur Dr.: Rt. 8  
 1107 E. Army Post Rd.: Rt. 6, 7  
 8601 Douglas Ave., Urbandale: Rt. 93

1700 Valley West Dr., West Des Moines:  
 Rt. 3, 52, 72, 94

1990 Grand Ave., West Des Moines: Rt. 72, 96

555 S. 51st St., West Des Moines: Rt. 52, 72, 96

1725 Jordan Creek Pkwy., West Des Moines\*:  
 Rt. 52, 94, 95, 72

7101 University Ave., Windsor Heights: Rt. 3, 74

100 8th St. SW, Altoona: Rt. 99

4815 Maple Dr., Pleasant Hill: Rt. 10

410 N. Ankeny Blvd., Ankeny: Rt. 98

2510 SW State St., Ankeny: Rt. 98

### Walmart

1002 SE National Dr., Ankeny\*: Rt. 98

1001 73rd St., Windsor Heights\*: Rt. 3, 74

Routes are listed next to the Pass Sales Outlet locations they service. Next nearest route(s) are also listed.

\* Locations where tokens are not available.

+ Passes only for Monthly, HalfFare Monthly, and Monthly Express Plus (no tokens or weekly).

## Fares

### Local Routes

Adult ..... \$ 1.75  
 HalfFare\*\*^ ..... \$ .75  
 Children 6 – 10 ..... \$ .75  
 Children 5 and under ..... FREE  
*(Must be accompanied by an adult)*

### Express Routes

Cash ..... \$ 2.00  
 HalfFare\*\*^ ..... \$ .75

### Tokens

*Tokens must be purchased in packages of 10.*

Full Fare ..... 10/\$ 17.50  
 HalfFare (Reduced Fare ID\*\*^\*) ..... 10/\$ 7.50

### Passes

Day Pass (Local, Express) ..... \$ 4.00  
 Half Fare Day Pass (Local, Express)\*\*^ ..... \$ 2.00  
 Weekly (Local) ..... \$ 16.00  
 HalfFare Weekly\*\*^ ..... \$ 7.00  
*(Local, Express & On Call)*  
 Monthly (Local) ..... \$ 48.00  
 HalfFare Monthly\*\*^ ..... \$ 24.00  
*(Local, Express & On Call)*  
 Monthly Express Plus ..... \$ 58.00  
*(Local, Express & On Call)*

### On Call Service

Cash ..... \$ 3.50  
 HalfFare\*\*^ ..... \$ .75

### Veterans Ride Free

Thanks to a partnership with Polk County Veterans Affairs, veterans can ride Local, Express and On Call service for free when they show a photo ID indicating veteran status upon boarding.

### Please Remember

DART requires exact fares and all special IDs upon boarding.

All DART locations are smokefree pursuant to the Iowa Smokefree Air Act.  
 Transfer times are not guaranteed.

### CUSTOMER SERVICE ..... 515-283-8100

\*Applies to adults 65+, persons with disabilities and refugees.

^Applies to middle and high school students in Polk County with current school year ID. Student discount is valid with cash or tokens.

May be asked for additional identification to validate use/sale of half-fares or passes. Contact DART Customer Service for more information about the Half Fare program.

Information found on this schedule can be provided in an alternative format upon request. Please contact Customer Service at 515-283-8100 to speak to a representative or email [dart@ridedart.com](mailto:dart@ridedart.com). DART will do its best to provide the requested alternative format within a reasonable timeframe.

**Des Moines Area Regional Transit Authority**  
**620 Cherry Street, Des Moines, Iowa 50309**

515-283-8100 ▶ [ridedart.com](http://ridedart.com)



## Customer Service Phone Hours

Monday – Friday  
 6 a.m. – 7 p.m.  
 Saturday & Sunday  
 8 a.m. – 4 p.m.

## Customer Service Window Hours

Monday – Friday  
 6:30 a.m. – 7 p.m.  
 Saturday & Sunday  
 8 a.m. – 4 p.m.

## Building Hours

Monday – Friday  
 5 a.m. – 11 p.m.  
 Saturday  
 6 a.m. – 10 p.m.  
 Sunday  
 7 a.m. – 6 p.m.

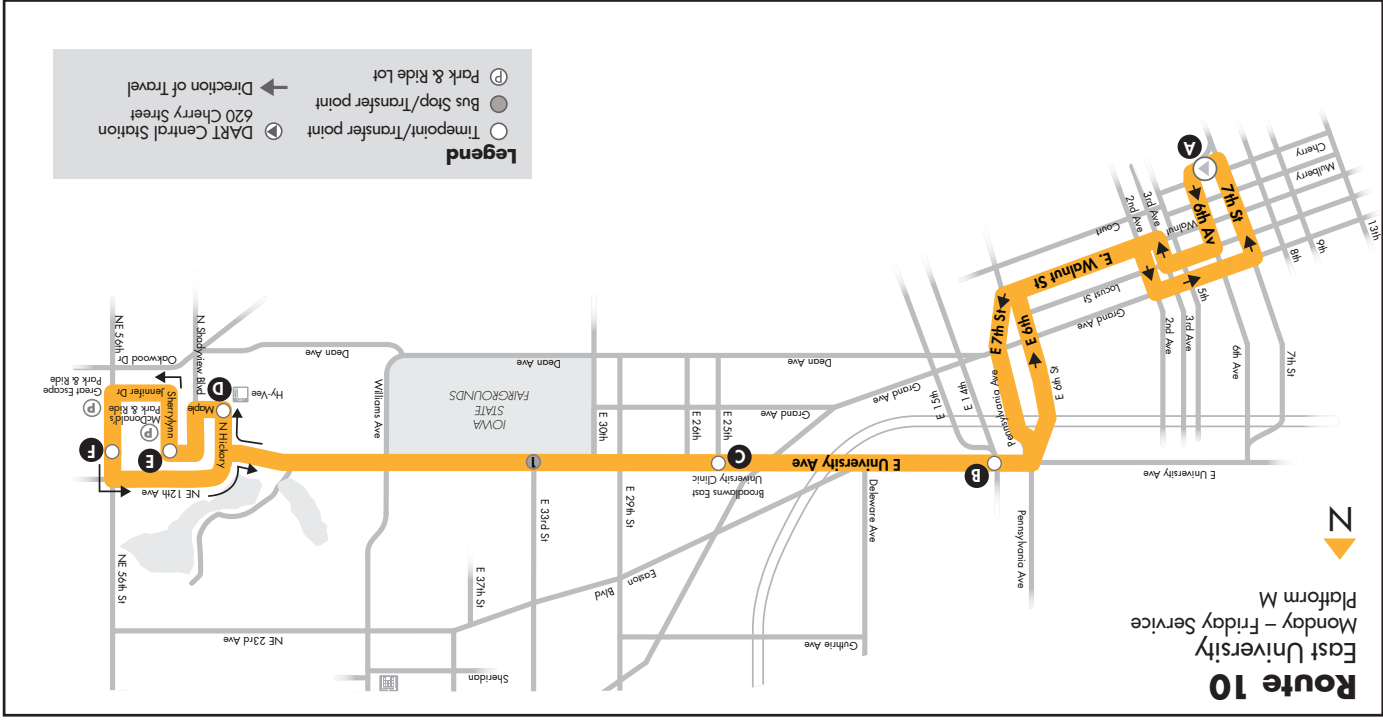

### EASTBOUND-Outbound Monday-Friday

DART Central Station	E University & E 14th	E University & E 25th (Broadlawns)	Maple Dr & Hy-Vee	Sherryllyn & E University
A	B	C	D	E
—	—	—	5:47	5:50
6:25	6:35	6:38	6:44	6:47
7:25	7:36	7:39	7:45	7:48
8:25	8:35	8:38	8:43	8:46
3:30	3:43	3:47	3:55	3:58
4:35	4:48	4:53	5:01	5:04
5:45	5:58	6:02	6:09	6:12

AM

PM

► Weather, special events and traffic conditions may alter service.

### WESTBOUND-Inbound Monday-Friday

Sherryllyn & E University	NE 56th & E University	E University & E 25th (Broadlawns)	E University & E 14th	DART Central Station
E	F	C	B	A
5:50	5:52	6:02	6:06	6:17
6:50	6:52	7:02	7:07	7:19
7:50	7:52	8:04	8:09	8:21
8:50	8:52	9:02	9:06	9:18
4:00	4:02	4:12	4:17	4:30
5:06	5:08	5:18	5:23	5:36
6:14	6:16	6:26	6:31	6:44

AM

PM

Stay connected with DART

Follow @ridedart on Facebook, Twitter and Instagram

Download the MyDART app

Plan trips, buy bus passes and get next bus times. Available on Android and iOS devices.

Get detour and service updates

Sign up for email alerts at [ridedart.com/email-updates](http://ridedart.com/email-updates)